



## GIS ELECTRIC CHAIN HOISTS (UP TO 5000 KG)

A further evolution in chain hoist development from GIS, specialists in chain hoist manufacture since 1963. The GIS manufacturing facility in Switzerland contains some of the most modern machining centres and the hoist embodies the latest manufacturing techniques and technology.

- Designed and manufactured to work in the most extreme of conditions
- Lifting capacity from 125–5000kg
- Hoist body and end covers manufactured from die cast aluminium
- Reliable, low wear, easy to maintain
- Single or dual speeds available with many different speed options
- Permanent hoist lubrication for wear resistant operation
- Cast aluminium housing and end covers using the latest casting technology, maximum solidity, no plastics used
- New advanced brake design providing maximum safety with minimum maintenance
- Five or six pocket chain wheel giving extremely quiet running
- 42V control system, electrical geared limit switches fitted as standard
- Fitted with mechanical stops to prevent over travel as required in FEM standards
- Ergonomic design 2 or 4 button control pendant with E stop
- Available with Eye or Hook suspension, push or electric trolley on I-Beams or combined with GIS crane system





# GIS GCH ELECTRIC CHAIN HOIST

6

Types	Duty Classification/Lifting Capacity					Lifting speed (m/min)	Motor power (kW)	3 x 400V 50Hz (A)	No. Of chain falls	Eye/hook suspension weight 3m lift (kg)	Weight per extra metre lift (kg)
	M3 1Bm 150 s/h 25% duty (kg)	M4 1Am 180 s/h 30% duty (kg)	M5 2m 240 s/h 40% duty (kg)	M6 3m 300 s/h 50% duty (kg)	M7 4m 360 s/h 60% duty (kg)						
GCH 250/1N	250	200	160	125	100	8	0.36	1.3	1	19	0.32
GCH 250/1NF	250	200	160	125	100	8/2	0.36/0.09	2.7/3.0	1	22	0.32
GCH 250/1SF	160	125	100	80	60	12.5/3	0.36/0.09	2.7/3.0	1	22	0.32
GCH 250/1HF	100	80	60	50	40	20/5	0.36/0.09	2.7/3.0	1	22	0.32
GCH 250/2N	500	400	320	250	200	4	0.36	1.3	2	22.5	0.64
GCH 250/2NF	500	400	320	250	200	4/1	0.36/0.09	2.7/3.0	2	23	0.64
GCH 250/2SF	320	250	200	160	125	6.25/1.5	0.36/0.09	2.7/3.0	2	23	0.64
GCH 500/1N	500	400	320	250	200	8	0.72	2.1	1	20	0.52
GCH 500/1NF	500	400	320	250	200	8/2	0.72/0.18	2.9/3.0	1	22.5	0.52
GCH 500/1SF	320	250	200	160	125	12.5/3	0.72/0.18	2.9/3.0	1	22.5	0.52
GCH 500/1HF	200	160	125	100	80	20/5	0.72/0.18	2.9/3.0	1	22.5	0.52
GCH 500/2N	1000	800	630	500	400	4	0.72	2.1	2	22.5	1.04
GCH 500/2NF	1000	800	630	500	400	4/1	0.81/0.18	2.9/3.0	2	25	1.04
GCH 500/2SF	630	500	400	320	250	6.25/1.5	0.81/0.18	2.9/3.0	2	25	1.04
GCH 1000/1N	1000	800	630	500	400	8	1.45	3.7	1	45	1.04
GCH 1000/1NF	1000	800	630	500	400	8/2	1.45/0.36	4.0/2.8	1	46	1.04
GCH 1000/1SF	500	400	320	250	200	16/4	1.45/0.36	5.8/2.6	1	48	1.04
GCH 1000/2N	2000	1600	1250	1000	800	4	1.45	3.7	2	50	2.08
GCH 1000/2NF	2000	1600	1250	1000	800	4/1	1.45/0.36	4.0/2.8	2	51	2.08
GCH 1000/2SF	1000	800	630	500	400	8/2	1.45/0.36	5.8/2.6	2	53	2.08
GCH 1600/1N	1600	1250	1000	800	630	8	2.44	6.0	1	63	1.75
GCH 1600/1NF	1600	1250	1000	800	630	8/2	2.44/0.61	6.6/4.2	1	65	1.75
GCH 1600/1SF	1000	800	630	500	400	12.5/3	2.39/0.58	6.6/4.2	1	65	1.75
GCH 1600/2N	3200	2500	2000	1600	1250	4	2.44	6.0	2	73	3.5
GCH 1600/2NF	3200	2500	2000	1600	1250	4/1	2.44/0.61	6.6/4.2	2	75	3.5
GCH 1600/2SF	2000	1600	1250	1000	800	6.25/1.5	2.39/0.58	6.6/4.2	2	75	3.5
GCH 2000/1N	2000	1600	1250	1000	800	8	3.05	7.3	1	65	2.25
GCH 2000/1NF	2000	1600	1250	1000	800	8/2	3.05/0.77	8.0/4.5	1	67	2.25
GCH 2000/1SF	1250	1000	800	630	500	12.5/3	2.98/0.72	8.0/4.5	1	67	2.25
GCH 2000/2N	4000	3200	2500	2000	1600	4	3.05	7.3	2	76	4.5
GCH 2000/2NF	4000	3200	2500	2000	1600	4/1	3.05/0.77	8.0/4.5	2	78	4.5
GCH 2000/2SF	2500	2000	1600	1250	1000	6.25/1.5	2.98/0.72	8.0/4.5	2	78	4.5
GCH 2500/1N	2500	2000	1600	1250	1000	6.4	3.05	7.7	1	65	2.25
GCH 2500/1NF	2500	2000	1600	1250	1000	6.4/1.6	3.05/0.77	8.2/4.4	1	67	2.25
GCH 2500/1SF	1600	1250	1000	800	630	10/2.5	3.05/0.77	8.2/4.4	1	67	2.25
GCH 2500/2N	5000	4000	3200	2500	2000	3.2	3.05	7.7	2	76	4.5
GCH 2500/2NF	5000	4000	3200	2500	2000	3.2/0.8	3.05/0.77	8.2/4.4	2	78	4.5
GCH 2500/2SF	3200	2500	2000	1600	1250	5/1.25	3.05/0.77	8.2/4.4	2	78	4.5

Specification – GIS-GCH Electric Chain Hoist 110V or 220V single phase power supply

Types Duty	Classification/ Capacity 1Bm 150 s/h 25% duty					Lifting speed (m/min)	Motor power (kW)	3 x 400V 50Hz (A)	1 x 230V 50Hz (A)	No. Of chain falls	Eye/hook suspension weight 3m lift (kg)	Weight per extra metre lift (kg)
GCH 250/1N 1Ph	160					8	0.23	-	8.9	1	19	0.32
GCH 250/2N 1Ph	320					4	0.23	-	8.9	2	22.5	0.64
GCH 500/1N 1Ph	250					8	0.36	-	8.9	1	20	0.52
GCH 500/2N 1Ph	500					4	0.36	-	8.9	2	22.5	1.04
GCH 500/1NL 1Ph	500					4	0.36	-	8.9	1	20	0.52
GCH 500/2NL 1Ph	1000					2	0.36	-	8.9	2	22.5	1.04
GCH 1000/1NL 1Ph	500					8	TBA	-	TBA	1	45	1.04
GCH 1000/2NL 1Ph	1000					4	TBA	-	TBA	2	50	2.08

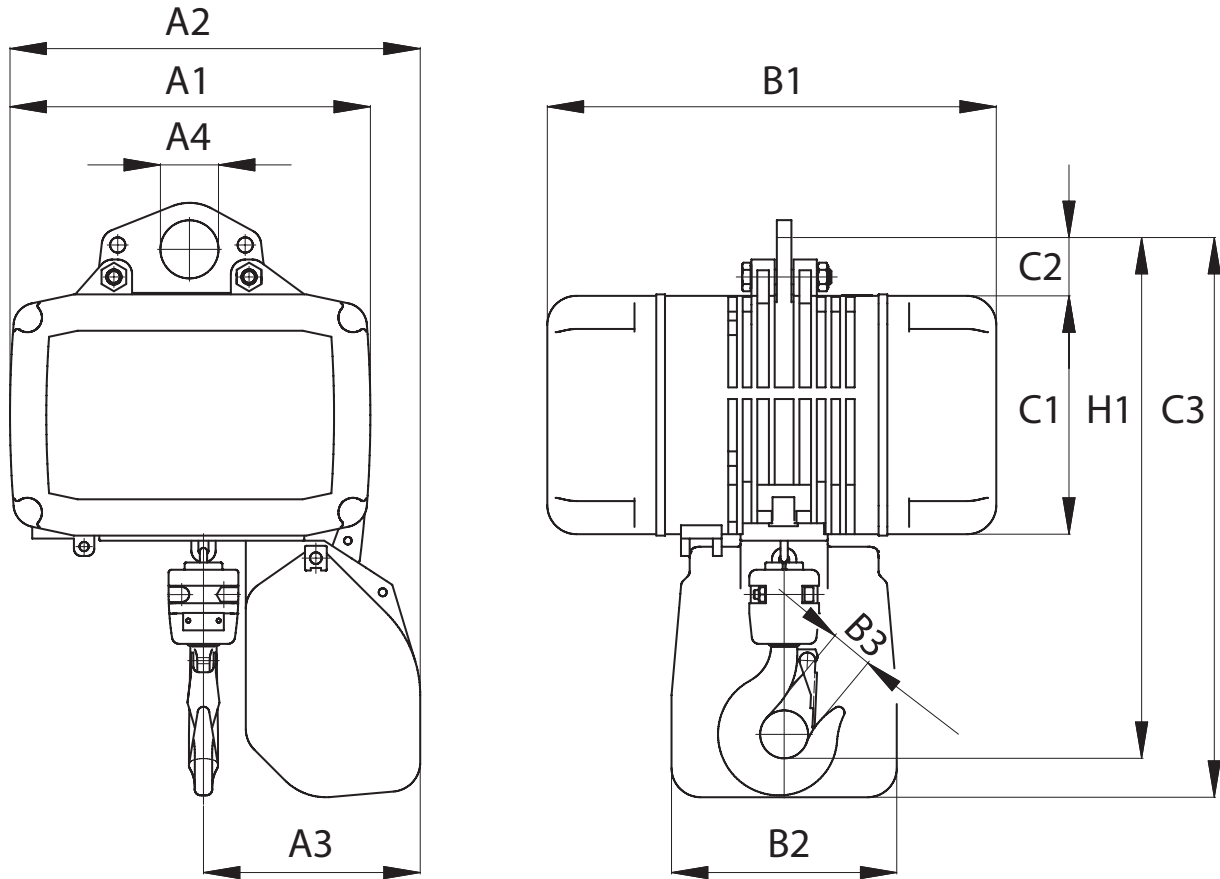

7

**DIMENSIONS (mm)**

Types	A1 mm	A2 mm	A3 mm	A4 mm	B1 mm	B2 mm	B3 mm	C1 mm	C2 mm	C3 mm	H1 mm
GCH 250/1	246	281	146	40	309	155	22	164	53	448	369
GCH 250/2	246	281	164	40	309	155	22	164	53	448	408
GCH 500/1	246	281	146	40	309	155	22	164	53	448	377
GCH 500/2	246	281	164	40	309	155	22	164	53	448	417
GCH 1000/1	321	367	190	52	367	180	32	214	69	615	482
GCH 1000/2	321	367	224	52	367	180	32	214	69	615	556
GCH 1600/1	345	424	221	75	389	180	37	230	135	696	608
GCH 1600/2	345	424	263	75	389	180	37	230	135	696	690
GCH 2000/1	345	424	221	75	389	180	37	230	135	696	608
GCH 2000/2	345	424	263	75	389	180	37	230	135	696	690
GCH 2500/1	345	424	221	75	389	180	37	230	135	696	608
GCH 2500/2	345	424	263	75	389	180	37	230	135	696	690



ISO (FEM) classification	M3 (1Bm) 150 s/h 25% duty	M4 (1Am) 180 s/h 30% duty	M5 (2m) 240 s/h 40% duty	M6 (3m) 300 s/h 50% duty	M7 (4m) 360 s/h 60% duty	Travelling speed	Motor power (M3)	3 x 400V 50Hz (M3)	Self weight	Electric or manual
Type	Capacity (kg)					(m/min)	(kW)	(A)	(kg)	
EHF 50	1,000	800	630	630	500	-	-	-	7.5	Manual
EMFE 50/N	1,000	800	630	630	500	12	0.25	0.8	27	Electric
EMFE 50/NF	1,000	800	630	630	500	12/4	0.15/0.045	0.65/0.75	27	Electric
EMFE 50/SF	800	800	630	630	500	20/6	0.15/0.045	0.65/0.75	27	Electric
EHF 150	2,000	2,000	1,600	1,600	1,250	-	-	-	13.5	Manual
EMFE 150/N	2,000	2,000	1,600	1,600	1,250	12	0.25	0.8	31	Electric
EMFE 150/NF	2,000	2,000	1,600	1,600	1,250	12/4	0.15/0.045	0.65/0.75	31	Electric
EMFE 150/SF	1,600	1,600	1,600	1,600	1,250	20/6	0.15/0.045	0.65/0.75	31	Electric
EHF 300	4,000	4,000	3,200	2,500	2,500	-	-	-	27.5	Manual
EMFE 300/N	4,000	4,000	3,200	2,500	2,500	12	0.25	0.8	50	Electric
EMFE 300/NF	4,000	4,000	3,200	2,500	2,500	12/4	0.15/0.045	0.65/0.75	50	Electric
EMFE 300/SF	3,200	3,200	3,200	2,500	2,500	20/6	0.15/0.045	0.65/0.75	50	Electric
EHF 500	5,000	4,000	3,200	3,200	2,500	-	-	-	27.5	Manual
EMFE 500/N	5,000	4,000	3,200	3,200	2,500	12	2x0.25	2x0.8	57	Electric
EMFE 500/NF	5,000	4,000	3,200	3,200	2,500	12/4	2x0.15/0.045	2x0.65/0.75	57	Electric
EMFE 500/SF	4,000	4,000	3,200	3,200	2,500	20/6	2x0.15/0.045	2x0.65/0.75	57	Electric

## DIMENSIONS (mm)

8

Types	e1 (mm)	e2 (mm)	f1 (mm)	f2 (mm)	f3 (mm)	f4 (mm)	f5 (mm)	f6 (mm)
EHF 50	215	-	-	-	-	183	23	-
EMFE 50	215	62	209	250	241	183	23	-
EHF 150	250	-	-	-	-	230	27	-
EMFE 150	250	43	211	253	242	230	27	-
EHF 300	311	-	-	-	-	290	31	-
EMFE 300	311	12	217	259	249	290	31	-
EHF 500	311	-	-	-	-	290	31	-
EMFE 500	311	12	-	259	249	290	31	249

Types	g1 (mm)	g2 (mm)	h2 (mm)				Flange width (mm)
			GCH 250/1	GCH 250/2	GCH 500/1	GCH 500/2	
EHF 50	49	167	418	457	426	466	50 - 99
EMFE 50	49	167	418	457	426	466	50 - 99
			GCH 1000/1	GCH 1000/2			
EHF 150	60	203	542	616			76 - 139
EMFE 150	60	203	542	616			76 - 139
			GCH 1600/1	GCH 1600/2	GCH 2000/1	GCH 2000/2	
EHF 300	55	218	637	719	637	719	120 - 179
EMFE 300	55	218	637	719	637	719	120 - 179
			GCH 2500/1	GCH 2500/2			
EHF 500	55	218	637	719			120-179
EMFE 500	55	218	637	719			120-179

### Options

- other flange widths
- electric travel trolley with brake
- Standard voltages: 3Ph 230V, 50Hz; 3Ph 400V, 50Hz
- Special voltages: on request
- Selection of travel trolleys:
  - GCH 250/500: EHF/EMFE 50
  - GCH 1600/2000: EHF/EMFE 300
  - GCH 1000: EHF/EMFE 150
  - GCH 2500: EHF/EMFE 500



EHF 50/150

EHF 50/150

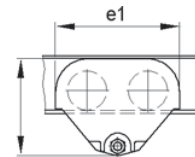

EHF 300/500

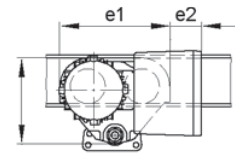

EMFE 300/500

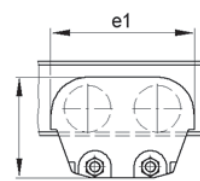

EHF 50/150/300/500

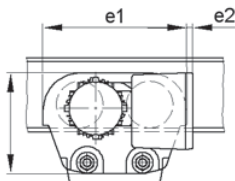

EMFE 50/150/300/500

