

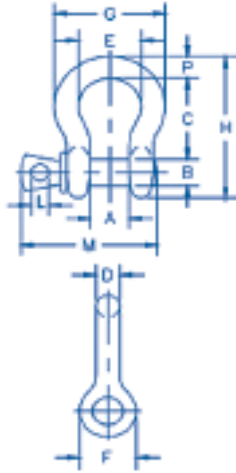

Shackles - Crosby Type

Crosby Screw Red Pin Bow Shackles – Carbon grade shackles with alloy pin, hot dip galvanized. Meets US Federal Spec RR-C-271D: Type IV A, Grade A, Class 2.

- Forged from alloy steel, quenched and tempered to give greater strength and abrasion resistance
- Marked with size, working load limit and batch number in raised lettering
- Safety factor 6:1
- Fatigue rated and proof tested with certificates
- Larger capacity shackles on request



Specifications & Dimensions (mm)

Working load limit (t)	Nominal size (in.)	Pin diameter Ø (in.)	Dimensions (mm)													Tolerance +/-		Weight each (kg)
			A	B	C	D	E	F	G	H	L	M	P	C	A			
0.5	1/4	5/16	11.9	7.85	28.7	6.35	19.8	15.5	32.5	46.7	4.85	35.1	6.35	1.50	1.50	0.05		
1	3/8	7/16	16.8	11.2	36.6	9.65	26.2	23.1	45.2	63.0	6.35	51.5	9.65	3.30	1.50	0.14		
2	1/2	5/8	20.6	16.0	47.8	12.7	33.3	30.2	58.5	83.5	9.65	68.5	12.7	3.30	1.50	0.33		
3.25	5/8	3/4	26.9	19.1	60.5	16.0	42.9	38.1	74.5	106.0	11.2	85.0	17.5	6.35	1.50	0.62		
4.75	3/4	7/8	31.8	22.4	71.5	19.1	51.0	46.0	89.0	126.0	12.7	101.0	20.6	6.35	1.50	1.07		
6.5	7/8	1.0	36.6	25.4	84.0	22.4	58.0	53.0	102.0	148.0	12.7	114.0	24.6	6.35	1.50	1.64		



Shackles - Economy Type

- Carbon grade shackles with alloy pin, hot dip galvanized. Meets US Federal Spec RR-C-271D: Type IV A, Grade A, Class 2.
- Forged from alloy steel, quenched and tempered to give greater strength and abrasion resistance
- Marked with size, working load limit and batch number in raised lettering
- Safety factor 6:1
- Proof tested with certificates
- Capacity 2.0 to 6.5 tonnes available as standard, others on request

Specifications & Dimensions (mm)

Working load limit (t)	Nominal size (in.)	Pin diameter Ø (in.)	Dimensions (mm)			Weight each (kg)
			Shackle opening	Shackle depth inside	Radius	
0.50	6.00	8.00	12.00	25.00	10.00	0.06
1.00	10.00	11.00	16.00	31.00	13.00	0.15
2.00	13.00	16.00	22.00	43.00	16.00	0.37
3.20	16.00	19.00	27.00	51.00	21.50	0.65
4.75	19.00	22.00	31.00	59.00	25.50	1.06
6.50	22.00	25.0	36.00	73.00	29.00	1.56





Roundslings



- Capacity 2000 kg in black colour with printed label. Polyester with heavy-duty single thickness seamless cover
- Circumference available 1, 2, 3, 4, 5, 6, 7, 8, 10 metres. Roundslings are measured and quoted in circumference rather than length

- Available up to 20m circumference, 10m length
- Supplied in black to reduce visibility but other capacities and colours available

Specification

Capacity	(t)	2.0	2.0	2.0	2.0	2.0	2.0	2.0	2.0	2.0
Circumference	(m)	1.0	2.0	3.0	4.0	5.0	6.0	7.0	8.0	10.0
Length	(m)	0.5	1.0	1.5	2.0	2.5	3.0	3.5	4.0	5.0

Other roundslings are available on request.



Soft Steels



- A range of Soft Steels with a roundsling type black fabric cover and steel wire rope load bearing interior. These are fire resistant and reduce damage to truss etc
- Available in circumference up to 6m
- Suitable for use in temperatures from -40 to +250 degrees C

Specification

Capacity	(t)	2.0	2.0	2.0	2.0	2.0	2.0
Circumference	(m)	1.0	2.0	3.0	4.0	5.0	6.0
Length	(m)	0.5	1.0	1.5	2.0	2.5	3.0



Steel/Wire Rope Slings & Chain Slings



- LTM are able offer a wide range of Steel wire rope slings to suit your rigging needs on site; from truss slings to secondary safety ropes
- Standard steels in 10mm diameter for 1000kg SWL, 13mm diameter for 2000kg, both with 6x19Fibre Core Galvanised wire ropes
- If required we can offer larger slings of 3000kg and above
- Plastic tubing can be offered as a protection feature

- We offer standard or tapered ferrule with or without inspection holes
- We also offer colour coding on thimbles so you can see your stock at a glance; making life easier for tackle inspection
- Both single and multi leg slings in various configurations can be supplied to your specification

CM Stac® Chain

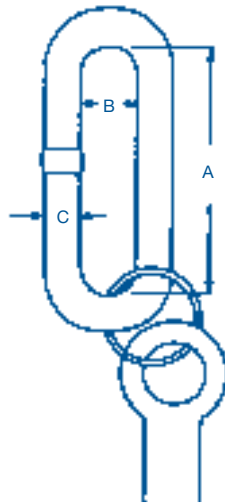

- Special theatrical alloy chain for rigging applications where bridle adjustability is required, also useful for tightening safety steels
- High strength heat treated alloy steel chain with a 12.7 mm diameter, a working load limit of 5400 kg with a 4:1 design factor
- Fire resistant
- Adjustable to approximate 4" (100 mm), will accept up to 4.75 t shackle
- Made from heat treated alloy steel - fire proof and abrasion resistant
- Proof tested and certified; complete with chain tag
- Standard length 1.5 m but any length available

Specification & Dimension (mm)

Capacity (t)	Dimensions (mm)			Weight (kg/m)
	A	B	C	
5.4	94.9	24.1	12.7	6.04

Beam Clamps



Capacity 1- 5 tonnes

- Designed to locate on the flanges of beams via a screw arrangement
- Acts as a semi permanent lifting point, Black finish
- Suitable for hanging chain hoists or other lifting devices
- With shackle suspension as standard, load pin suspension available on request
- Available in the following capacities and beam sizes

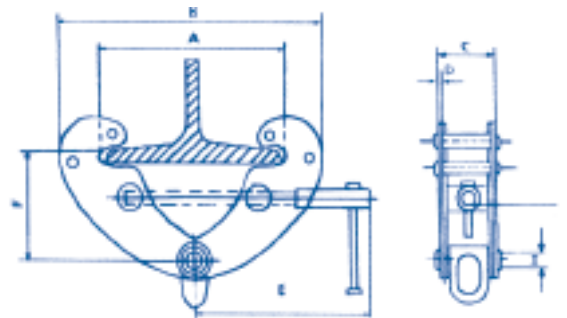

Specification & Dimension (mm)

Lifting capacity	Adjustable beam width	A max	B min	B max	C	D	E	F max	F min	G min	H	Weight (kg)
1 tonne	70-245	270	183	375	66	4	210	165	102	25	20	4.4
2 tonne	70-245	270	183	375	74	6	210	165	102	25	20	5.1
3 tonne	70-355	365	240	520	103	8	258	225	135	45	22	10.5
5 tonne	70-355	365	240	520	111	10	258	225	135	45	28	17
10 tonne	80-350	365	250	520	120	12	280	230	160	50	38	19



Load Arrester

- Load Arresters automatically stop the free fall of a suspended load if the primary hoist system or suspension point fails
- This provides protection for vulnerable equipment or to people below the suspended load
- The load arrester senses the increase in cable speed and activates the braking system. Energy is absorbed by the system and the

load is stopped smoothly within a short distance

- The load arresters incorporate an indicator giving an immediate and clear signal showing that the device has been used in a fall
- Special features in the design enable the device to be used in a variety of positions and in the harshest environments



Specifications & Dimension (mm)

Working load limit	(kg)	250	250	250	500	500	500	1500	1500
Cable length	(m)	7	10	14	7	10	15	7	9
Stopping distance	(m)	0.9	0.9	0.9	1.0	1.0	1.0	0.7	0.7
Rope speed to activate braking system	(m/sec)	0.9	0.9	0.9	0.9	0.9	0.9	0.6	0.6
Weight	(kg)	9	9	9.25	15	15.5	16	22	24



Fall Arrester



- Fall arresters automatically stop the free fall of a person in the event of a fall
- Should a fall occur, cable is pulled out of the arrester at an accelerating rate. When a cable speed of approximately 1.5 metres per second is reached the unique twin disc pad braking

mechanism is activated, arresting the fall quickly and smoothly greatly reducing the resultant forces acting on the body

- When the load is released the cable retracts into the block

Specification & Dimension (mm)

Working load limit	(kg)	136	136	136	136	136
Cable length	(m)	7	14	20	28	34
Stopping distance	(m)	0.6	0.6	0.8	1.0	1.0
Rope speed to activate braking system	(m/sec)	1.5	1.5	1.5	1.5	1.5
Weight	(kg)	10.0	10.5	15.0	21.0	21.0



Automatic Descent Lifeline

- A fall arrester which stops a falling person within 1.5m then lowers the person to floor level at a speed of 2 m/ second. Avoiding the necessity of a rescue being necessary after a fall
- Automatic cable return

- Manufactured from powder coated cast aluminium, galvanised rope and hook and stainless steel bolts. Sealed housing
- Load indicator shows when a fall has occurred

Specification

Working load limit	(kg)	136	136
Type		FP 2/5	FP 3/5
Cable length	(m)	15	33
Stopping distance	(m)	1.5	1.5
Rope speed to activate braking system	(m/sec)	1.5	1.5
Max arresting force	(kn)	6	6
Average descent speed	(m/sec)	1.2	1.8
Weight	(kg)	10	17

